

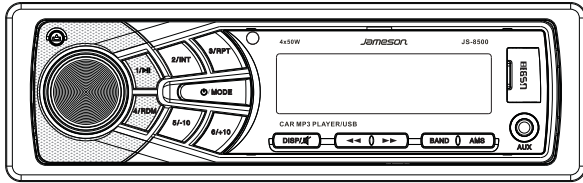

JS-8500

INSTRUCTION MANUAL



MP3 PLAYER / RECEIVER
USB/SD/MMC/AUX SLOT

INSTALLATION

INPUT THE SD CARD

The SD oblique angle keeps Rightward exposure. put into the SD slot and press it again to eject.

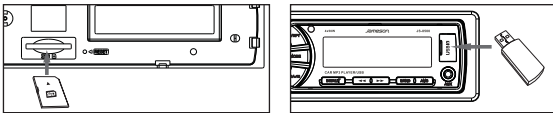

GENERAL OPERATIONS

FRONT PANEL LAYOUT

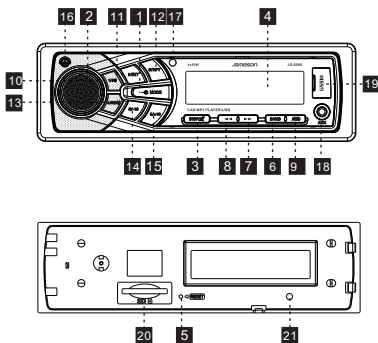

- 1 Power/MOD Button
- 2 Volume/Sel Button
- 3 Display/Mute Button
- 4 LCD Display
- 5 Reset Button
- 6 Band switch/ID3 select
- 7 Tune Seek & Track forward Button
- 8 Tune Seek & Track reverse Button
- 9 Automatically memory storing
- 10 Play/pause & Preset Button 1
- 11 Intro & Preset Button 2
- 12 Repeat & Preset Button 3
- 13 Random & Preset Button 4
- 14 Preset Button 5
- 15 Preset Button 6
- 16 Release Button
- 17 Remote Control sensor
- 18 AUX IN JACK
- 19 USB connector
- 20 SD/MMC slot
- 21 Flashing LED

INSTALLATION

PRECAUTIONS

Choose the mounting location where the unit will not interfere with the normal driving function of the driver.

Before finally installing the unit, connect the wiring temporarily and make sure it is all connected up properly and the unit and the system work properly.

Use only the parts included with the unit to ensure proper installation. The use of unauthorized parts can cause malfunctions.

Consult with your nearest dealer if installation requires the drilling of holes or other modifications of the vehicle.

Install the unit where it does not get in the driver's way and cannot injure the passenger if there is a sudden stop. Like an emergency stop.

Avoid installing the unit where it would be subject to high temperature, such as from direct sunlight, or from hot air, from the heater, or where it would be subject to dust, dirt or excessive vibration.

DIN FRONT-MOUNT (Method A)

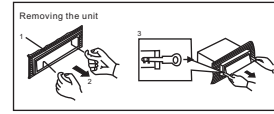

1. Frame
2. Insert fingers into the groove in the front of frame and pull out to remove the frame. (When reattaching the frame, point the side with a groove downwards and attach it.)
3. Lever
Insert the levers supplied with the unit into the grooves at both sides of the unit and shown in figure until they click. Pulling the levers makes possible to remove the unit from the dashboard.

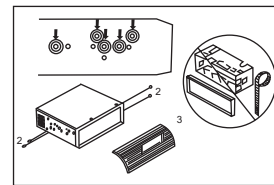

- Fastening the unit to the factory radio mounting bracket:
1. Select a position where the screw holes of the bracket and the screw holes of the main unit become aligned (are fitted), and tighten the screws at 2 places on each side. Use either truss screws (5 x 5mm).
 2. Screw
 3. Dashboard or Console.

DIN REAR-MOUNT (Method B)

Installation using the screw holes on the sides of the unit.

GENERAL OPERATIONS

GENERAL OPERATIONS

POWER /MOD conversion

2. Under power off status, short press is power on, Under power on status, short press is switching mode, long press is power off.

SOUND ADJUSTMENT

Turn on (2) can adjust the desired volume quality. Press SEL button (2) will change in the following order.

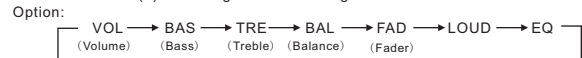

VOLUME

Adjust volume level by using VOL/SEL (2) knob. Turn the VOL knob to left to decrease the sound level, turn the VOL knob to right to increase the sound level. Note: The unit is initially set to volume mode.

BASS

Press VOL/SEL button(2) one time. Adjust bass level by using VOL/SEL(2) Knob.

TREBLE

Press VOL/SEL button(2) two times. Adjust treble level by using VOL/SEL(2) Knob.

BALANCE

Press VOL/SEL button(2) three times. Adjust sound balance between left and right speakers by using VOL/SEL(2) Knob.

FADER (optional)

Press SEL button(2) four times. Adjust sound balance between front and rear speakers by using VOL/SEL(2) Knob.

SELECT MENU

Press VOL/SEL button for several seconds, selecting menu is activated as cyclical mode of following function for use's selection:

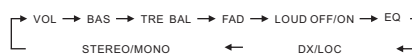

Press VOL/SEL button shortly and turn VOL button to right or left to select different menu mode.

EQ OFF/ON

Select "EQ ON" → POP → CLASS → ROCK → EQ OFF menu male.

LOUD ON/OFF MODE

In loud on mode the bass and treble response will be boosted.

STEREO/MONO

When FM station are weak and are disturbed. Listening can be improve by selecting MONO.

Replacing the Battery

When the operational range of the remote control becomes short or non replacement. Replace a new CR2025 battery. Make sure the battery polarity before operating.

1. Pull out Battery Holder while pressing the stopper
2. Put the button type battery (+) mark upward into the Battery Holder.
3. Insert the Battery Holder into the Remote control

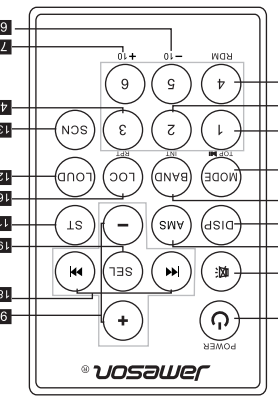

- Remote Control Optional**
- 1 Power Button
 - 2 Pause/play / Preset Button1
 - 3 Info/ Preset Button2
 - 4 Repeat Playing/ Preset Button3
 - 5 Random/ Preset Button4
 - 6 Preset Buttons
 - 7 Preset Button6
 - 8 Mute Button
 - 9 Volume Control
 - 10 Mode Switch
 - 11 ST/MO Button
 - 12 Loudness Button
 - 13 Scan Button
 - 14 Display Button
 - 15 APS/ AMS Button
 - 16 LOC/DX Button
 - 17 Band Switch
 - 18 Tuning/ Selecting Tracks/ F / F / F / R
 - 19 Select Button

REMOTE CONTROL LAYOUT

LOCAL/DX

"LOCAL" position in areas with strong signals to let radio stop at only strong stations during manual turning select distant position in areas with weak signals to listen to all stations.

AREA SETUP

In Radio mode, Press SEL button for several seconds, LCD will be show from BEEP ON → AREA USA/EUR, AT AREA USA/EUR, You can use VOL +/- to select the AREA frequency.

Note: *On Remote Control

Short press "DISP" button to turn on the mute, Press "DISP" again to turn off the mute.

Long press "DISP", LCD screen shows clock "00:00". Short press "DISP", the hour flashes, rotate "VOL +/-" to adjust hour. Press "SEL" button, minute flashes, rotate "VOL +/-" to adjust the minute, if there is no operation within 5 seconds, the unit will memorize the current time and return to current mode.

RESET

RESET button (5) is placed on the housing and must be activated with either a ball point pen or thin metal object. (Do not use sharp object to avoid damaging the unit.). The RESET button (5) is to be activated for the following reasons:

- Initial installation of the unit when all wiring is completed.
- All the function buttons do not operate.
- Error symbol on the display.

RADIO OPERATIONS

BAND SELECTION

At tuner mode, press BAND button (6) to select the desired band. The reception band will change in the following order:

FM1 → FM2 → FM3

STATION SELECTION

During radio mode, Press "SEEK <<<" or "SEEK >>>" buttons more than 1 second is operated as a station, Press "SEEK <<<" or "SEEK >>>" buttons shortly to automatically search

RESET

RESET button (5) is placed on the housing and must be activated with either a ball point pen or thin metal object. (Do not use sharp object to avoid damaging the unit.). The RESET button (5) is to be activated for the following reasons:

- Initial installation of the unit when all wiring is completed.
- All the function buttons do not operate.
- Error symbol on the display.

GENERAL OPERATIONS

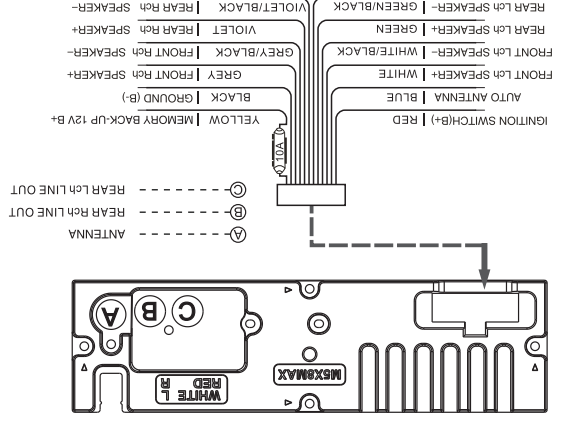

ADDITIONAL INFORMATION

Specifications subject to change without notice

Remarks:

FM Radio

- Frequency Coverage (MHz): 87.5 - 108MHz
- IF: 10.7MHz
- Sensitivity (S/N-30dB): >30dB
- Stereo Separation: More than 60dB
- Channel Separation: More than 60dB
- Frequency Response: 20Hz - 20KHz
- Signal to Noise Ratio: More than 60dB

USB/SD MUSIC PLAYER

- Bass (at 100Hz): +10dB / -10dB
- Treble (at 10K): +10dB / -10dB
- Current Drain: 10A
- Chassis Dimensions: 178 x 130 x 50mm (W x D x H)
- Maximum Output Power: 50W x 4 (CH)
- Load Impedance: 4 ohms
- Power Supply Requirements: DC 14.4V "==" , Negative Ground

Tone Controls

General

- Power Supply Requirements: DC 14.4V "==" , Negative Ground
- Load Impedance: 4 ohms
- Maximum Output Power: 50W x 4 (CH)
- Chassis Dimensions: 178 x 130 x 50mm (W x D x H)
- Current Drain: 10A
- Bass (at 100Hz): +10dB / -10dB
- Treble (at 10K): +10dB / -10dB

SPECIFICATION

AUTOMATICALLY MEMORY STORING & PROGRAM SCANNING

- Automatically Memory Storing
- Press AMS(MP3) button (9) for several seconds, the radio searches from the current frequency and checks the signal strength until one cycle search is finished.
- And then 6 strongest stations are stored into the corresponding preset number button.
- Program Scanning
- Press AMS(MP3) button (9) shortly to scan preset station. When the AMS mode is carry out, "INT" appear on LCD display, the unit scan each stored station for 5 seconds, you also can press the corresponding number button or AMS button. Your desired station will start playing.

STATION STORING

Press preset button (11-16)

RADIO MODE

M1 ~ M6

- PRESET MEMORY is loaded when key is pressed for less than 1 second.
- PRESET MEMORY is saved when key is pressed for longer than 1 sec.

USB/SD OPERATIONS

USB/SD FLASH MP3 Playing:

PLAY / PAUSE

Press button (10) pause function is activated. Music track play time INDICATOR flashes. Press it again to resume playing, press it more than 1 second its TOP function.

INT

Press button (11): During INTRO ON, INT indicator comes on and begins playing the first 10sec of each song, until the last song is played, it begins playing the entire track from where INT started

RPT

Press preset button (12): Flash play mode : REPEAT ON / OFF is activated.

RDM

When REPEAT ON, RPT INDICATOR comes on and repeats the current music track.

Press preset button (13): During RANDOM ON, RDM INDICATOR is turned on and each track of disc is played in random instead of normal order.

SELECT TRACKS

During USB/SD operation, press SEEK "◀" (8) button or SEEK "▶" (7) button to move to the previous track or the following track. Track number shows on display. During USB/SD, hold SEEK "◀" (8) button or SEEK "▶" (7) to fast reverse or fast forward. Music play starts from when you release the button.

Press preset button (15-16):

- MP3 MODE : 10 TRACK UP / DOWN is activated.
- When the total track is 10 or less, KEY is inactivated.

RADIO OPERATIONS