

Instruction Manual

Jameson®



TR-15PRO

Please read this instruction manual carefully before using and save it for future reference.

WARNING



Use / Safety Instructions

Please read all safety instructions carefully before use.

For reference in the future, please keep manual properly.

Please follow the instruction manual.

- * If there is any problem with the product, please contact the merchant in time, and do not repair the product host.
- * Do not use it under the circumstances, otherwise there will be electric shock, fire and other damage: high temperature in the bathroom, supermarket, dripping water.
- * Do not use water to rinse or corrode liquid to wipe any position of the product, which may cause damage to the internal electronic components and appearance of the product.
- * Please turn off the main unit after fully charged and place it in a cool and dry place. please charge it at least once every three months to avoid overdischarging of the battery.
- * It is forbidden to discard discarded batteries, incinerate batteries, or place them in any liquid, and should be disposed of by a professional recycling agency.
- * If you need to transport the product, please make sure that the main unit is turned off and it is recommended to use the package.

Battery charging and maintenance

This unit able to operate on a built-in Li-ion battery that can be recharged either using from power adaptor .

- * For the first time using, please charge the machine for 8 hours to make it fully charged.
- * In use process, when the low voice or LED lights hint electric machine, please charge in time.
- * If not for a long time to use the machine, please every three to four months to recharge a native.
- * Be sure the charger's voltage and current settings are correct for the battery pack being charged.
- * Recycle Li-ion batteries. Do not dispose of in the trash.

Control Panel

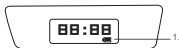

1. Battery power icon. It shows battery power and status.

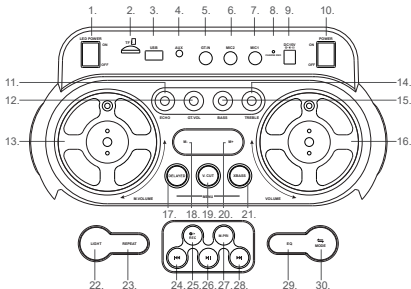

1. LED POWER: LED light to turn on or off.
2. TF: Please insert TF card to play back music. The mode will switch to TF mode when insert TF card automatically.
3. USB: Please insert USB to play back music. The mode will switch to USB mode when insert USB automatically. Noted: If both TF and USB are inserted, all songs in USB and TF keep looping.
4. AUX: Connect an external audio device to speaker.
5. GT.IN: Connect a Guitar device.
6. MIC 2: Connect a microphone.
7. MIC 1: Connect a microphone.
8. CHARGE LED: Red LED turn on when charging battery. It will turn blue after fully charged.
9. DC in: Connect a DC15V/2A power from adapter or other source power to charge your speaker. Please charge speaker when  flash that means the battery is low. Attention: Please turn off unit for battery charging.
10. POWER: Switch to turn on or turn off your speaker.
11. ECHO: Rotate to adjust echo sound effect.

Control Panel

12. GT.VOL: Rotate to increase or decrease guitar volume.
13. M.VOLUME: Rotate to adjust microphone volume.
14. TREBLE: Rotate to increase or to decrease treble.
15. BASS: Rotate to increase or decrease bass.
16. VOLUME: Rotate to increase or decrease volume.
17. DELAYED: press "DELAYED" then press " M-" to decrease or press " M+" to increase microphone delayed effect.
18. M-: decrease effect depends on menu item.
19. V. Cut: press to cut vocal of music.
20. M+: increase effect depends on menu item.
21. X-BASS: press "X-BASS" then press " M-" to decrease or press " M+" to increase X-BASS effect.
22. LIGHT: press to select lighting mode.
23. Repeat: Press to repeat playback currently music program in USB or TF; press again to repeat all music program.
24. REV/CH-: Press to previous sound track. In FM mode to select previous FM station.
25.  REC : Please insert a USB device and microphone. Press and hold to recode microphone voice into USB; press again to stop and then playback it.
26. Play/Pause/SCAN/PAIR: Press to play music, press again to pause music. In FM mode to scan FM station then memorized station automatically. Hold to disconnect BT connection in BT mode.
27. M.PRI: Press to set microphone priority first, press again return priority off.
28. NEXT/CH+: Press to next sound track. In FM mode to select next FM station.
29. EQ: Press to select EQ preset from ROCK, POP, CLASSIC and Normal cyclic.
30. MODE: Press to select BT/FM/AUX function cyclic.

PAIRING A BLUETOOTH DEVICE

1. Turn on your Bluetooth device.
2. Turn on the speaker Bluetooth, the unit will automatically go into pairing mode to search for Bluetooth device. You will know you are in pairing mode when the display "bt" is flash quickly.
3. If your Bluetooth device is not able to pair to the unit, check whether it had been connected, break the previous Bluetooth connections and reset the Bluetooth module. Hold play key to disconnect and enter pairing mode.
4. Navigate to your Bluetooth device's setup screen, find "TR-15PRO" and connect. "bt" show steady if connected.
5. Note: You can connect with a smart phones or tablet PC with Bluetooth.

TWS Connection

Please prepare 2 units, turn on power and set in Bluetooth mode.

1. Press and hold "Play/Pause" button of 2 units at the same time. The units will enter in TWS mode and connect with each other automatically.
2. Connect your Bluetooth device with the unit.
3. Playback music after BT connection completed.
4. Press and hold "Play/Pause" button to exit TWS mode.

TROUBLE SHOOTING

Power failure

1. Please check VOLUME/POWER turn on.
2. Please charge battery when battery low indicator shown in display.

No Sound

1. Please check VOLUME.
2. In AUX IN mode, please check your external audio device and AUX cable.
3. In MIC mode, please check your microphone.

USB/TF no sound:

Please check your TF/USB had music.

FM no sound or sound weak.

Please move your speaker to other location. May be FM station signal is weak.

SPECIFICATION

POWER SOURCE : DC 15V \pm 2A (for charge only)

POWER CONSUMPTION: 100W

FM FREQUENCY: 87.5-108 MHz

RANGE OF FREQUENCY: 40Hz~20KHz

